

REV.	DESCRIPTION	DRAWN	CHECKED	APPROVED
A	NEW RELEASE	YCH 09/04/08'	~	LJC 09/04/08'
B	HOUSING CHANGE	JLZ 06/27/15'	HZW 06/27/15'	LJC 06/27/15'
C	DRAWING UPDATE	JLZ 01/31/18'	~	

NOTES:

- MATERIAL
  - INSULATOR: THERMOPLASTIC(UL 94V-0).
  - CONTACT MATERIAL: COPPER ALLOY.
- SPECIFICATION
  - CURRENT RATING: 1.0 Amp.
  - INSULATION RESISTANCE: 1000MΩ Min.
  - DIELECTRIC WITHSTANDING: 300VAC.
  - CONTACT RESISTANCE: 20mΩ Max.
  - OPERATING TEMPERATURE: -40°C TO +105°C.

3. PART NUMBER: DS1064-14

4. PRODUCT NUMBER CODE:

DS1064-14 - X X X X X - X

- PLATING LEVEL  
3A: 3A LEVEL
- PACKING TYPE  
B: TUBE  
R: TAPE ON REEL
- HOUSING COLOR  
B: BLACK
- CONTACT PLATING  
8: FULL GOLD FLASH  
6: FULL TIN
- MOUNTING TYPE  
S: SMT TYPE
- No. OF CONTACTS  
06 08 10 14 20 24 26 30  
32 34 40 44 50 60 64 80

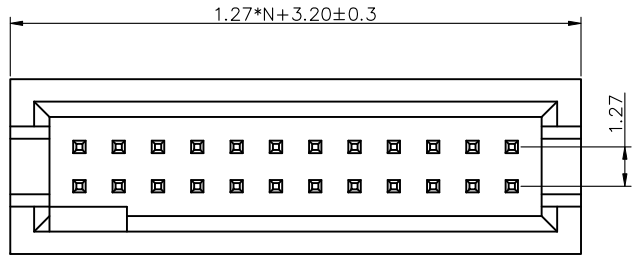

N=No.OF CONTACTS/2

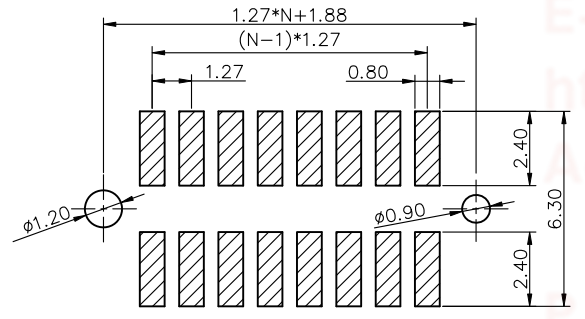
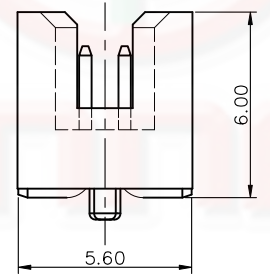
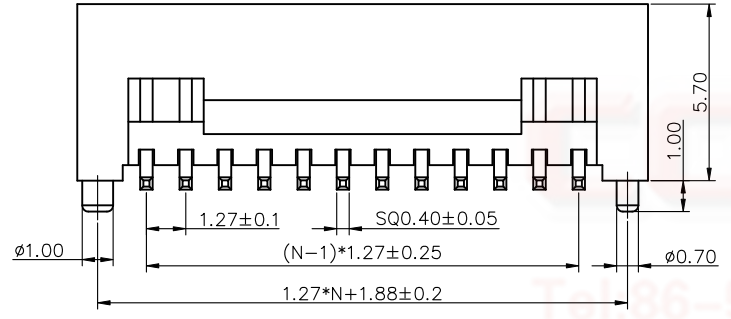

RECOMMEND PCB LAYOUT  
(TOLERANCE=±0.05)

GENERAL TOLERANCE		ANGLE TOLERANCE	
.X	±0.60	.X	±5°
.X	±0.38	.X	±3°
.XX	±0.25	.XX	±2°

PROJECTION	TITLE	1.27mm HEADER PITCH	
UNITS	mm	SMT TYPE W/POST	
SHEET SIZE	A4	SERIES	DS1064-14 SERIES

DRAWING TYPE	CUSTOMER		
SCALE	1:1	SHEET	1 OF 1
DRAWING NO.	C-DS1064-14-XXXXXX-X-C		

**晨翔电子有限公司**  
**CONNFLY CONNFLY ELECTRONIC CO. LTD**