

REV.	DESCRIPTION	DRAWN	CHECKED	APPROVED
A	NEW RELEASE	YCH 07/06/09	~	

NOTES:

- SPECIFICATION:
 - Current Rating: 3A.
 - Insulation Resistance: 1000MΩ min.
 - Dielectric Withstanding: 500V for One minute.
 - Contact resistance: 100mΩ max.
 - Operating Temperature: -40°C to +105°C

2. MATERIALS

- Housing: Thermoplastic(UL94 V-0)
- Contact: Copper alloy.
- Shell: Steel.
- Board Lock: Copper alloy

3. Product Number code:

DS1082-04 - X X X X X X

- Screw type
- 1: CC type 2: CS type
- 3: BB type 4: BS type

- Central distance(DIM. H)
- 1: 19.05mm
- 2: 15.88mm

- Housing color
- B: All black

- Contact plating
- 0: Selective gold flash
- 8: Full gold flash

UP connector type

- 15M: H.D-SUB standard 15pin male
- 15F: H.D-SUB standard 15pin female
- 26M: H.D-SUB standard 26pin male
- 26F: H.D-SUB standard 26pin female
- 44M: H.D-SUB standard 44pin male
- 44F: H.D-SUB standard 44pin female
- 62M: H.D-SUB standard 62pin male
- 62F: H.D-SUB standard 62pin female

DOWN connector type

- 15M: H.D-SUB standard 15pin male
- 15F: H.D-SUB standard 15pin female
- 26M: H.D-SUB standard 26pin male
- 26F: H.D-SUB standard 26pin female
- 44M: H.D-SUB standard 44pin male
- 44F: H.D-SUB standard 44pin female
- 62M: H.D-SUB standard 62pin male
- 62F: H.D-SUB standard 62pin female

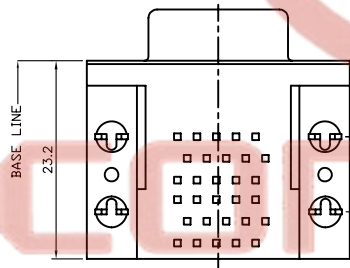
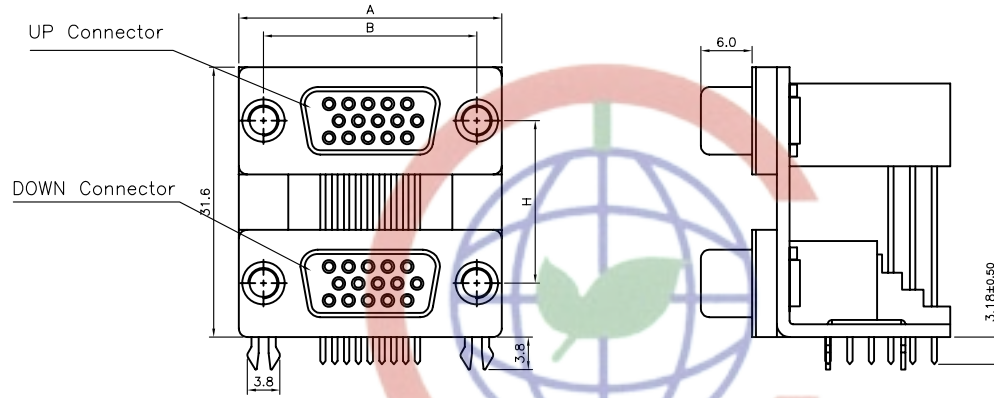

Positions	DIM A	DIM B
15	30.80	24.99
26	39.14	33.32
44	53.04	47.04

#4-40 UNC screw

#4-40 UNC screw

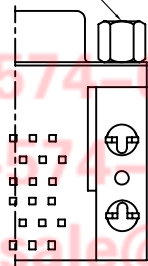
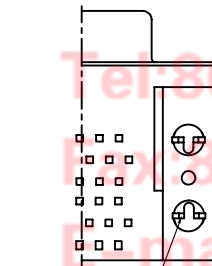
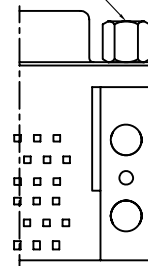
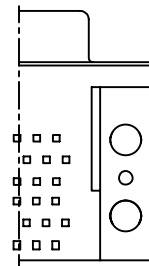

Board Lock

CC TYPE

CS TYPE

BB TYPE

BS TYPE

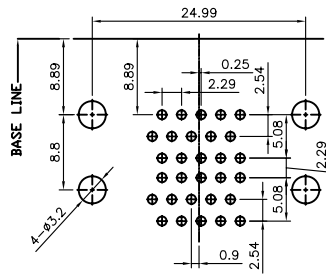

RECOMMEND PCB LAYOUT
(TOLERANCE=±0.05)

GENERAL TOLERANCE		ANGLE TOLERANCE		PROJECTION	TITLE		
X.	±0.60	X.	±5°		HIGH DENSITY D-SUB 2 IN 1		
.X	±0.38	.X	±3°			UNITS	mm
.XX	±0.25	.XX	±2°			SHEET SIZE	A4
DRAWING TYPE		CUSTOMER		SERIES	DS1082-04 SERIES		
SCALE		1:1	SHEET	1 OF 1			
DRAWING NO.		C-DS1082-04-XXXXXX					



晨翔电子有限公司

CONNFLY CONNFLY ELECTRONIC CO. LTD