

The information provided herein is from CONNFLY Electronic Co., Ltd. and is confidential. Any disclosure to a party other than the recipient is prohibited. The intellectual properties and its rights contained herein, including but not limited to, trademarks, patents, copyrights, trade secrets, and technical know-how, are owned exclusively by CONNFLY or its affiliates. Unauthorized use or modification is strictly prohibited. CONNFLY may enforce its intellectual property rights at its own discretion; failures or delays to exercise such rights does not constitute a waiver of such rights.

Dept	1	2	3	4	5	6	7	8
Qty	1							
DC	1							
ED	1							
IE	1							
ISO	1							
PD	1							
R&D	1							
SD	1							
QA	1							
QC	1							
QE	1							

REV.	DESCRIPTION	DRAWN	CHECKED	APPROVED
A	NEW RELEASE	LL 12/02/06'		LJC 12/02/06'
B	NEW RELEASE	JLZ 08/01/18'		

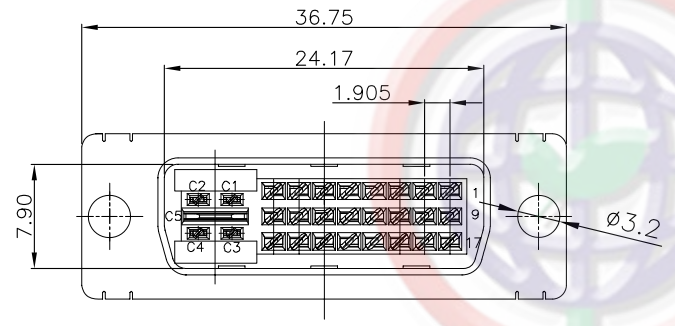

- NOTES:
- SPECIFICATIONS
 - Contact Resistance: 30mΩ max
 - Insulation Resistance: 1000MΩ min.
 - Current Rating: 1A
 - Dielectric withstanding voltage: AC 500V For 1 minute
 - Contact: Copper alloy.
 - Housing: Thermoplastic(UL 94V-0)
 - Resistance to soldering heat: 260±5°C 5±0.5s.
 - PRODUCT NUMBER CODE:
DS1089 - X X X X

- SCREW TYPE
- X:W/O SCREW
- S:W/ #4-40(UNC) SCREW
- Contact plating
- O: Selective gold flash
- Shell plating
- N: Front shell Nickel,Back shell Tin
- T: Front & back shell Tin
- Color of housing
- W: WHITE
- K: BLACK
- V: Ivory

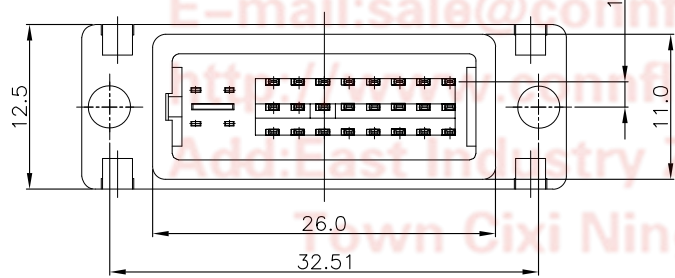
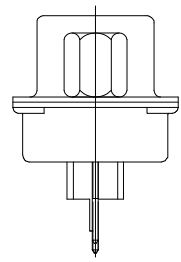
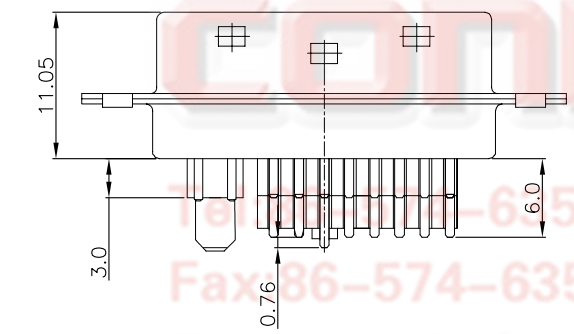
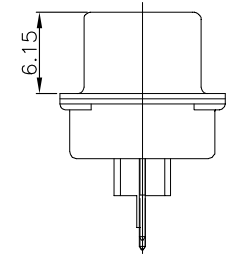

#4-40(UNC) SCREW

GENERAL TOLERANCE		ANGLE TOLERANCE		PROJECTION		TITLE	DVI PLUG 24+5	
X.	±0.60	X.	±5°	UNITS	mm	SHEET	A4	
.X	±0.38	.X	±3°	SHEET SIZE	A4	SERIES	DS1089 SERIES	
.XX	±0.25	.XX	±2°	晨翔电子有限公司 CONNFLY CONNFLY ELECTRONIC CO. LTD				
DRAWING TYPE		CUSTOMER						
SCALE		1:1	SHEET 1 OF 1					
DRAWING NO.		C-DS1089-XXXX-B						